

FEDERAL SPECIFICATION
CHAIN AND ATTACHMENTS, WELDED
AND WELDLESS

The General Services Administration has authorized the use of this amendment, which forms a part of Federal Specification RR-C-271D, dated 25 September 1990, by all federal agencies.

PAGE 5

TABLE I: Change footnote to read as follows: "Steel with carbon 0.50 (maximum) is permitted for attachments or attachment parts, types II, III, V, VI and VII, provided the fabrication is done without welding."

PAGE 18

3.5.3.1: Delete and substitute:

"3.5.3.1 General. Grade A shackles shall be forged from carbon steel as specified in 3.1.1.2.4. Pins and bolts for Grade A shackles shall be made from carbon or alloy steel as specified in 3.1.1.2.4. Grade B shackles together with their pins and bolts shall be forged from alloy steel as specified in 3.1.1.2.4."

PAGE 19

3.5.3.1.4: Delete and substitute:

"3.5.3.1.4 Working load limit. The working load limits of shackles covered by this specification shall be as shown in table XVII."

3.5.3.1.6: First sentence, delete "recommended safe working load" and substitute "working load limit (WLL)". Delete second sentence and substitute: "All shackle pins and bolts shall be marked with manufacturer's name or trademark; in addition, all alloy pins and bolts shall be marked with the raised or stamped letters 'HS' on the head."

3.5.3.2: Delete last sentence and substitute: "Except for reference dimensions, the dimensions of shackle bodies and component pins and bolts shall conform to the dimensional requirements specified in table XI through XVI. Reference dimensions are for information."

AMSC N/A

FSC 4010

DISTRIBUTION STATEMENT A. Approved for public release; distribution is unlimited.

RR-C-271D
AMENDMENT 1

PAGE 20

Figure 19: Delete in its entirety and substitute new page 20 (Figure 19), attached.

PAGE 21

Figure 20: Delete in its entirety and substitute new page 21 (Figure 20), attached.

PAGE 22

TABLE XI: Delete and substitute as follows:

First Column : Delete "Size" and substitute "Diameter body"; delete "minimum" and substitute "nominal*" with footnote as follows:

"*Minimum shall be no smaller than 5 percent under nominal, measured at the top. Cross-section may be elliptical, provided that minor diameter meets minimum requirement."

Second Column ("Diameter pin") : delete "minimum" and substitute "nominal**" with footnote as follows:

"**Minimum shall be no smaller than 2-1/2 percent under nominal."

Third Column ("Diameter inside eye") : Delete "maximum" and substitute "(ref)".

Fourth Column ("Width between eyes/nominal"): Delete "23/32" and substitute "3/4". Delete "5-3/4" and substitute "5-1/2". Delete "6-1/2" and substitute "5-1/2".

Fifth Column ("Width between eyes/tolerance") :

- Opposite sizes 1 through 1-1/4, delete "1/16" and substitute "1/8".
- Opposite sizes 1-3/4 through 2-1/4, delete "1/8" and substitute "3/16".
- Opposite sizes 2-1/2 and 3, delete "1/8" and substitute "1/4".

Sixth Column ("Length inside/nominal"):

- Opposite size 5/8, delete "2-13/32" and substitute "2-3/8".
- Opposite size 3/4, delete "2-27/32" and substitute "2-13/16".
- Opposite size 4, delete "17" and substitute "15".

Eighth Column ("Width bow"):

- Opposite size 9/16, delete "1-5/8" and substitute "1-3/8".

RR-C-271D
AMENDMENT 1

PAGE 23

TABLE XII:

- (1) Make same changes shown above for Table XI.
- (2) Ninth Column ("Major diameter threaded eye") - Delete "maximum" and substitute "(ref)".

PAGE 24

TABLE XIII:

- (1) Make same changes shown above for Table XI - First, Second, Third, Fourth, Fifth and Sixth Columns; the Fifth Column change also includes the following: Opposite size 2-3/4, delete "1/8" and substitute "1/4".
- (2) Insert size 3-1/2 with the following values: D = 3-1/2; P = 3-3/4; E = 3-29/32; W = 5-1/2 (+/- 1/4); L = 15 (+/- 3/4); B = 9; R = 8-1/2; Weight per 100 = 26,500.

PAGE 25

TABLE XIV:

Make same changes shown above for Table XI - First, Second, Third, Fourth and Fifth Columns.

PAGE 26

TABLE XV:

- (1) Make same changes shown above for Table XI - First, Second, Third, Fourth and Fifth Columns.
- (2) Eighth Column ("Major diameter threaded eye") - Delete "minimum" and substitute "(ref)".

PAGE 27

TABLE XVI: Make same changes shown above for Table XI - First, Second, Third, Fourth and Fifth Columns.

PAGE 28

Delete TABLE XVII in its entirety and substitute:

**RR-C-271D
AMENDMENT 1**

TABLE XVII. Mechanical properties.

Size D (Inches)	Working load limit (pounds)		Proof load (minimum) (pounds)		Breaking load (minimum) (pounds)	
	Grade A	Grade B	Grade A	Grade B	Grade A	Grade B
3/16	650	1,000	1,430	2,200	3,250	5,000
1/4	1,000	1,500	2,200	3,300	5,000	7,500
5/16	1,500	2,500	3,300	5,500	7,500	12,500
3/8	2,000	4,000	4,400	8,800	10,000	20,000
7/16	3,000	5,200	6,600	11,440	15,000	26,000
1/2	4,000	6,600	8,800	14,520	20,000	33,000
9/16	5,000	8,000	11,000	17,600	25,000	40,000
5/8	6,500	10,000	14,300	22,000	32,500	50,000
3/4	9,500	14,000	20,900	30,800	47,500	70,000
7/8	13,000	19,000	28,600	41,800	65,000	95,000
1-	17,000	25,000	37,400	55,000	85,000	125,000
1-1/8	19,000	30,000	41,800	66,000	95,000	150,000
1-1/4	24,000	36,000	52,800	79,200	120,000	180,000
1-3/8	27,000	42,000	59,400	92,400	135,000	210,000
1-1/2	34,000	60,000	74,800	132,000	170,000	300,000
1-5/8	40,000	70,000	88,000	154,000	200,000	350,000
1-3/4	50,000	80,000	110,000	176,000	250,000	400,000
2-	70,000	100,000	154,000	220,000	350,000	500,000
2-1/4	80,000	120,000	176,000	264,000	400,000	600,000
2-1/2	110,000	160,000	242,000	352,000	550,000	800,000
2-3/4	120,000	180,000	264,000	396,000	600,000	900,000
3-	170,000	220,000	374,000	484,000	850,000	1,100,000
3-1/2	240,000	280,000	528,000	616,000	1,200,000	1,400,000
4-	300,000	350,000	660,000	770,000	1,500,000	1,750,000

Custodians:
Navy -SH
Air Force - 99

Preparing activity:
Navy - SH
(Project No. 4010-0209)

Review activities:
Air Force - 82

RR-C-271D
 AMENDMENT 1

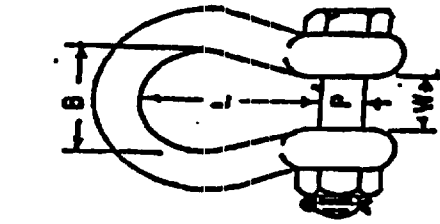

Class 3 safety
 anchor shackle.

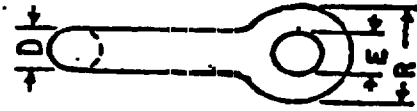

Class 2 screw pin
 anchor shackle.

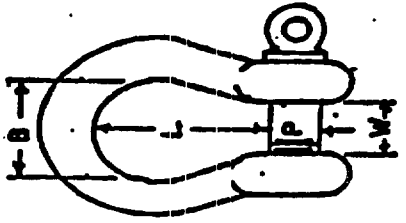

Class 1 round pin
 anchor shackle.

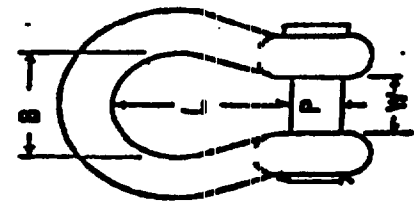

FIGURE 19. Type IVA anchor shackles.

Supersedes page 20 of RR-C-271D of 25 September 1990.

RR-C-271D
AMENDMENT 1

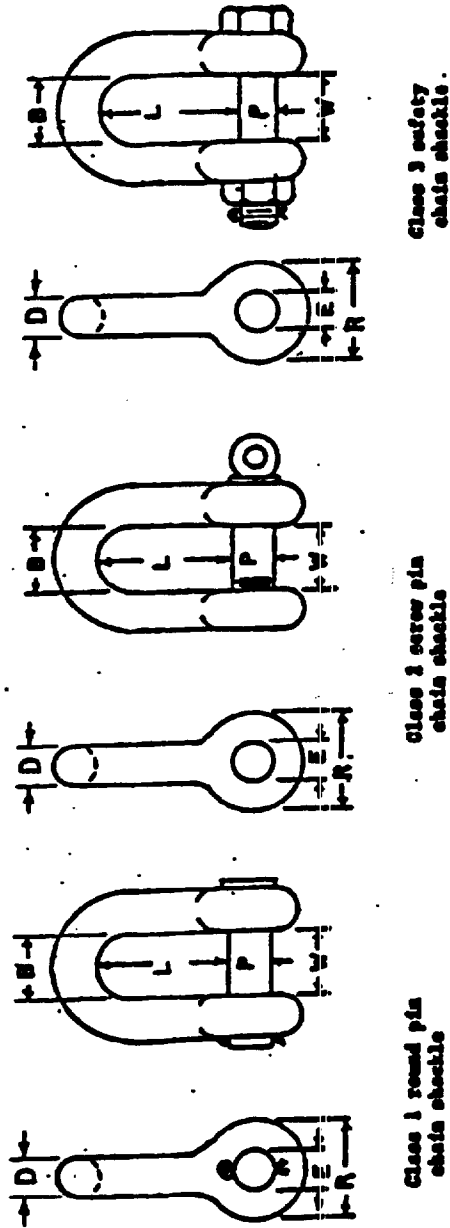

FIGURE 20. Type IVB chain shackles.

Supersedes page 21 of RR-C-271D of 25 September 1990.